

GMP SET

PROJECT NAME

**4 EYE STREET, SE
WASHINGTON, DC**

PROJECT NUMBER RCP09

OWNER
CRESCENT-RCP VENTURE I, LLC
227 West Trade Street, Suite 1000
Charlotte, NC 28202
D (202) 465-8455 / M (703) 216-2029
se@rcpdevelopment.com

ISSUE MARK	DATE	DESCRIPTION
-	10.27.2017	DD SET
4	02.02.2018	PERMIT SET
	02.21.2018	GAR
	02.21.2018	PERMIT RESPONSE
	04.27.2018	PERMIT RESPONSE
	05.11.2018	GMP SET

SEAL

KEYPLAN

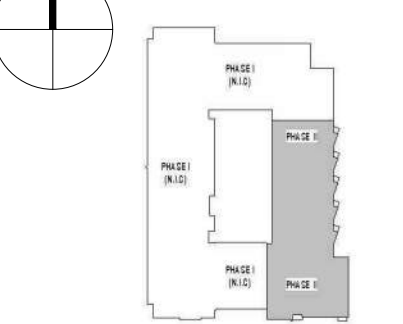

©2018 SK-I Architectural Design Group, LLC
THIS PROJECT IS PROTECTED BY COPYRIGHT
LAW AND INTERNATIONAL TREATIES

DRAWING TITLE
**MATERIALS PLAN-
STREET LEVEL**

DATE 5.11.2018

SCALE 1/8" = 1'

L003

PHASE I (N.I.C)

PHASE I (N.I.C)

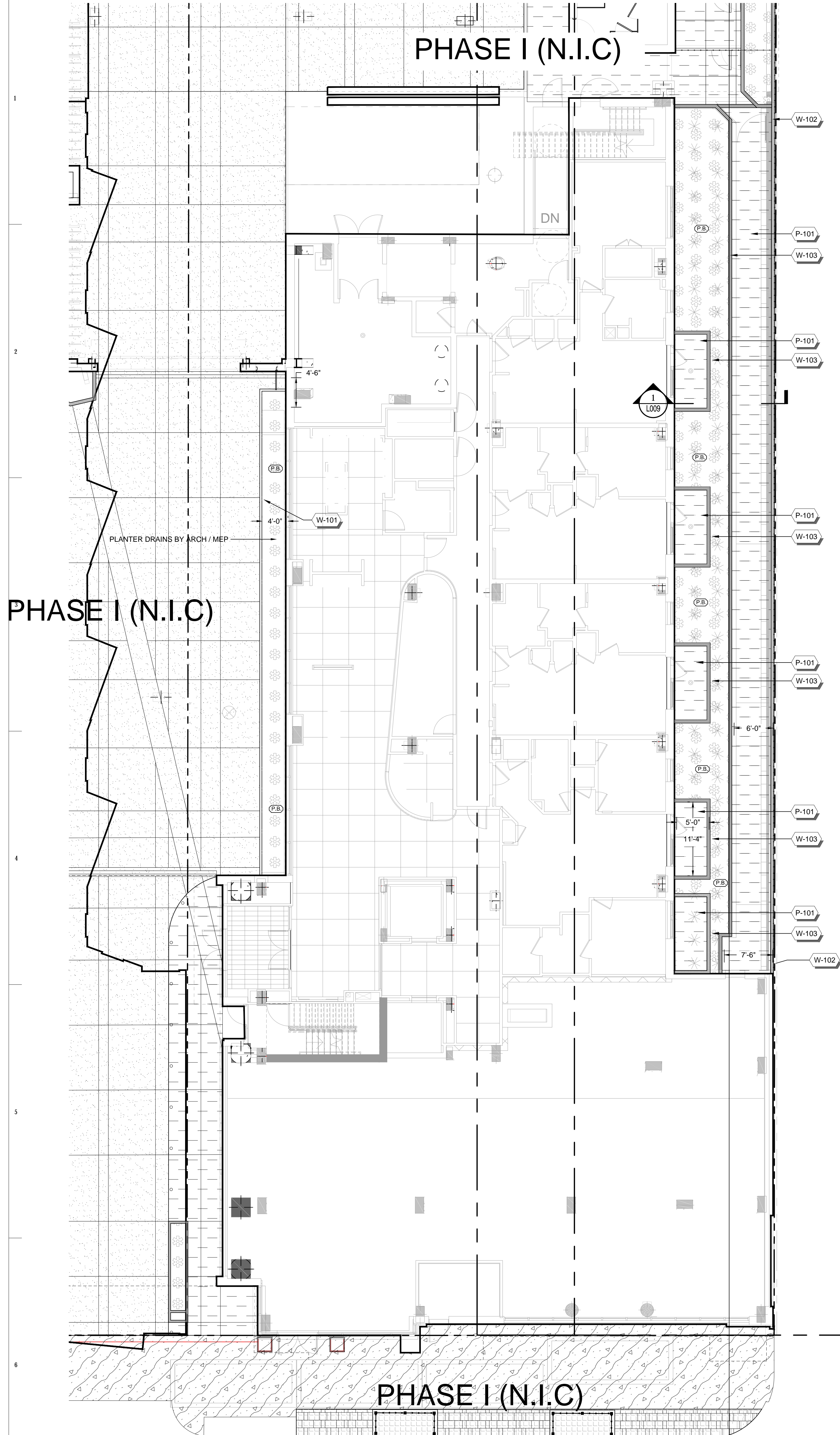

REFERENCE NOTES SCHEDULE GROUND FLOOR

SYMBOL	PAVING DESCRIPTION	DETAIL
(P-101)	PEDESTRIAN SPECIAL PAVING	3/L006

SYMBOL	WALL DESCRIPTION	DETAIL
(W-101)	PLANTER AT MOTOR COURT	2/L007
(W-102)	PERIMETER WALL AND FENCE	1/L007
(W-103)	PLANTER WALL	5/L007

NOTE:
1. SEE ARCHITECTURE FOR EXTERIOR HOSE BIB LOCATIONS.
2. NO MINERAL WOOL REQUIRED AT ANY 1ST FLOOR PLANTERS.

