

## FOR CONSTRUCTION SET

PROJECT NAME  
**4 EYE STREET, SE  
WASHINGTON, DC**

PROJECT NUMBER RCP09  
OWNER  
CRESCENT-RCP VENTURE I, LLC  
227 West Trade Street, Suite 1000  
Charlotte, NC 28202  
D (202) 465-8455 / M (703) 216-2029  
se@rcpdevelopment.com

ISSUE MARK	DATE	DESCRIPTION
-	10.27.2017	DD SET
-	02.02.2018	PERMIT SET
-	02.21.2018	GAR
-	02.21.2018	PERMIT RESPONSE
-	04.27.2018	PERMIT RESPONSE
-	05.11.2018	CMP SET
-	07.03.2018	IPC SET
Δ	01.11.2019	ASI 006.1

SEAL

KEYPLAN

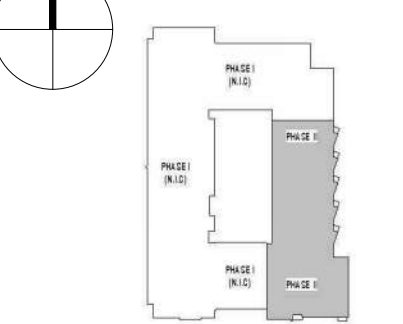

©2018 SK-I Architectural Design Group, LLC  
THIS PROJECT IS PROTECTED BY COPYRIGHT LAW AND INTERNATIONAL TREATIES

DRAWING TITLE  
**MATERIALS PLAN-  
14TH FLOOR**

DATE 07.03.2018

SCALE 1/8" = 1'

**L004**

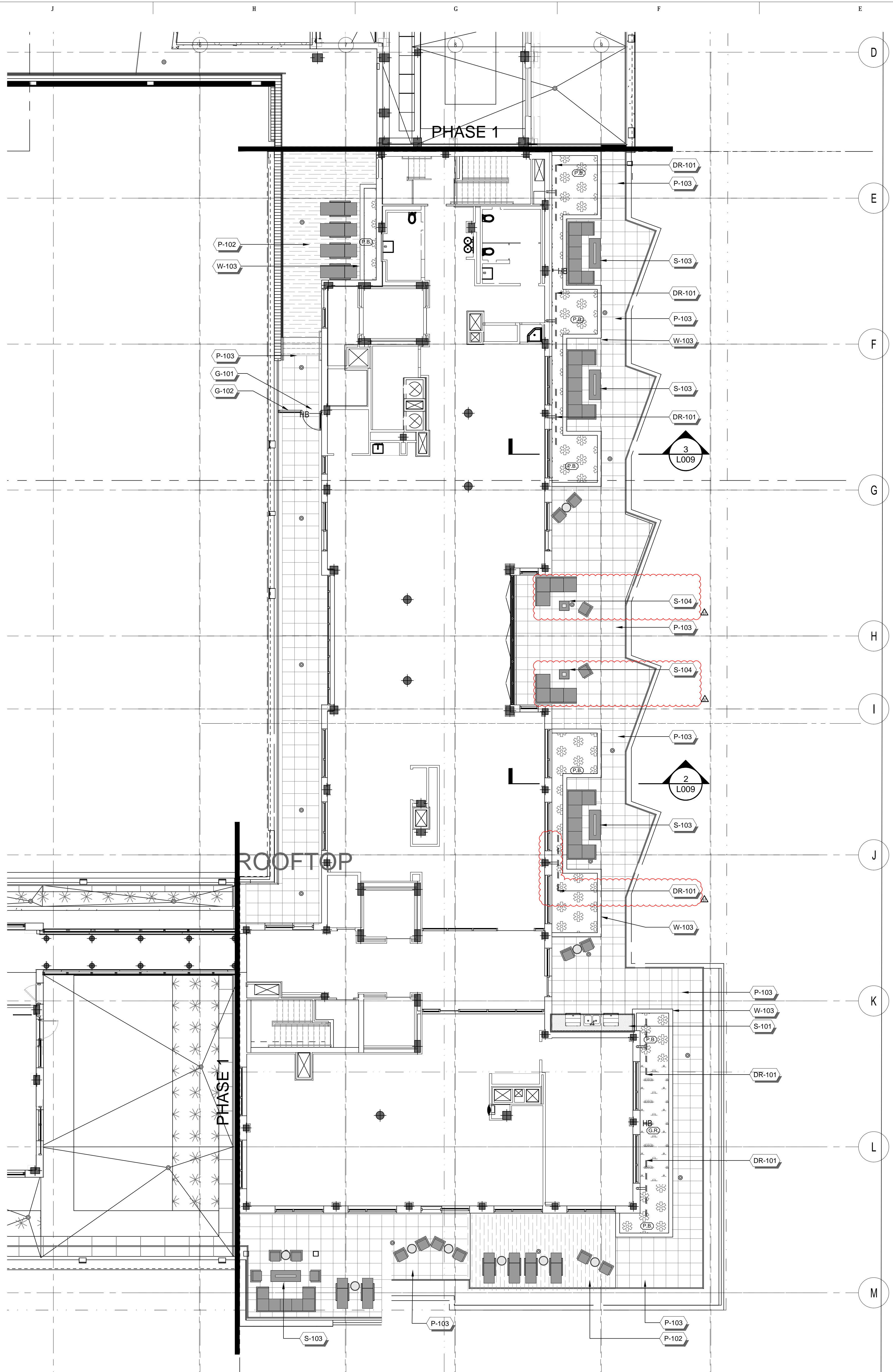

### REFERENCE NOTES SCHEDULE

SYMBOL	DRAINAGE DESCRIPTION	QTY	DETAIL
DR-101	ROOF LEADER	4/L009	
SYMBOL	GATE DESCRIPTION	QTY	DETAIL
G-101	POOL GATE	3/L007	
G-102	POOL ENCLOSURE	4/L007	
SYMBOL	PAVING DESCRIPTION	QTY	DETAIL
P-102	WOOD DECK	2/L006	
P-103	PEDESTAL PAVERS	1/L006	
SYMBOL	SITE FURNISHINGS DESCRIPTION	QTY	DETAIL
S-101	OUTDOOR GRILL STATION	2/L008	
S-103	LINEAR FIRE PIT	1/L008	
S-104	SQUARE FIRE FEATURE	4/L008 Δ	
SYMBOL	WALL DESCRIPTION	QTY	DETAIL
W-101	PLANTER AT MOTOR COURT	2/L007	
W-102	PERIMETER WALL AND FENCE	1/L007	
W-103	PLANTER WALL	5/L007	

- NOTE:  
1. SEE ARCHITECTURE FOR EXTERIOR HOSE BIB LOCATIONS.  
2. FURNITURE SHOWN FOR REFERENCE ONLY.  
3. NOT ALL ITEMS ON REFERENCE SCHEDULE APPEAR ON ALL SHEETS.

