

PLANT SCHEDULE PHASE II PLANTING

TREES	CODE	BOTANICAL NAME / COMMON NAME	CONT	CAL	HT.	
	BENI	BETULA NIGRA 'DURAHEAT' / DURAHEAT RIVER BIRCH	B&B OR CONTAINER	1 1/2"-2"		
	LITU	LAGERSTROEMIA INDICA 'TUSCARORA' / TUSCARORA CRAPE MYRTLE	B&B OR CONTAINER		6' - 8'	
	MGLG	MAGNOLIA GRANDIFLORA 'LITTLE GEM' / DWARF SOUTHERN MAGNOLIA	B&B OR CONTAINER	1 1/2"-2" CAL.		
SHRUBS	CODE	BOTANICAL NAME / COMMON NAME	SIZE	HEIGHT	SPREAD	
	ABRO	ABELIA X 'ROSE CREEK' / ROSE CREEK ABELIA	CONTAINER	12" - 24"	-	
	BUMF	BUXUS MICROPHYLLA 'FRANKLIN'S GEM' / FRANKLIN'S GEM BOXWOOD	CONTAINER	18" - 24"		
	BUGM	BUXUS X 'GREEN MOUND' / GREEN MOUND BOXWOOD	CONTAINER			
	CSYS	CALIBRACHOA X 'SUPERBELLS YELLOW CHIFFON' TM / MILLION BELLS	6" POT			
	COSF	CORNUS SERICEA 'FLAVIRAMEA' / YELLOW TWIG DOGWOOD	CONTAINER	18" - 24"		
	DIBC	DISTYLIUM X BLUE CASCADE / BLUE CASCADE DISTYLIUM	CONTAINER	18" - 24"	18" - 24"	
	JSBL	JUNIPERUS SQUAMATA 'EXPANSA PARSONII' / EXPANSA PARSONII JUNIPER	CONTAINER		24" - 30"	
	LCCO	LANTANA CAMARA 'CONFETTI' / CONFETTI LANTANA	6" POT			
	PLOL	PRUNUS LAUROCERASUS 'OTTO LUYKEN' / OTTO LUYKENS CHERRY LAUREL	CONTAINER		12"-24"	
	SEDA	SEDUM X 'AUTUMN JOY' / AUTUMN JOY SEDUM	1 GAL			
GROUND COVERS	CODE	BOTANICAL NAME / COMMON NAME	SIZE	COLOR	BLOOMS	SPACING
	ALAT	ALLIUM ATROPURPUREUM / ORNAMENTAL ONION	BULB			9" o.c.
	DRYI	DRYOPTERIS INTERMEDIA / INTERMEDIATE WOODFERN	1 GAL.			18" o.c.
	HEUA	HEUCHERA AMERICANA 'DALE'S STRAIN' / DALE'S STRAIN CORAL BELLS	1 GAL	WHITE		12" o.c.
	LMBB	LIRIOPE MUSCARI 'BIG BLUE' / BIG BLUE LILYTURF	1 GAL	LAVENDER		12" o.c.
	NATP	NASSELLA TENUISSIMA 'PONY TAILS' / MEXICAN FEATHERGRASS	1 GAL.			18" o.c.
	NERW	NEPETA RACEMOSA 'WALKER'S LOW' / CATMINT	1 GAL.			24" o.c.
	PEAL	PENNISETUM ALOPECUROIDES 'LITTLE BUNNY' / LITTLE BUNNY FOUNTAIN GRASS	1 GAL			18" o.c.
	SANC	SALVIA NEMOROSA 'CARDONNA' / CARDONNA PERENNIAL SALVIA	1 GAL.			18" o.c.

GREEN ROOF

- SEDUM MAT: (GRSM)
1. SEMPERGREEN SEDUM MAT B- GRADE WITH 50-80% COVERAGE.

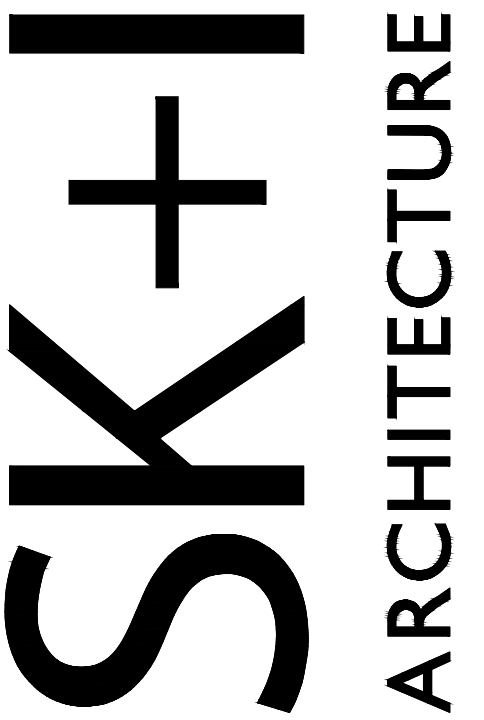

4600 East West Highway, Suite 700
Bethesda MD 20814
T 301.654.9300 / F 301.654.7211
company@skiarch.com

STRUCTURAL ENGINEER
EHLERT BRYAN
1451 Dolley Madison Blvd, Suite 220
McLean, VA 22101
T 703.827.9552
wbryan@ehlerbryan.com

MP CONSULTANT
HURST ENGINEERS, INC
308 Hillwood Ave
Falls Church, VA 22046
T 703-534-7872
dlyde@hurstengineers.com

ELECTRICAL DESIGN BUILD
POWER DESIGN
11600 Ninth Street North
St. Petersburg, FL 33716
T 727.568.7951
mzeiber@powerdesigninc.us

CIVIL ENGINEER
WILES MENSCH CORPORATION
739 8th Street, SE 2nd Floor
Washington, DC 20003
T 703.391.7600 / D 202.552.0241
mlopez@wilesmensch.com

LANDSCAPE ARCHITECTS
LANDESIGN, INC
200 South Peyton Street
Alexandria, VA 22314
T 703.549.7784
mclark@landesign.com

INTERIOR DESIGNERS
SK+I Architectural Design Group LLC
4600 East West Highway, Suite 700
Bethesda, MD 20814
T 301-654-9300
mradulescu@skiarch.com

IFC SET

PROJECT NAME

4 EYE STREET, SE
WASHINGTON, DC

PROJECT NUMBER RCP09

OWNER
CRESCENT-RCP VENTURE 1, LLC

227 West Trade Street, Suite 1000
Charlotte, NC 28202
D (202) 465-9455 / M (703) 216-2029
se@rcpdevelopment.com

ISSUE

MARK	DATE	DESCRIPTION
-	10.27.2017	DD SET
02	02.2018	PERMIT SET
02	21.2018	GAR
02	21.2018	PERMIT RESPONSE
04	27.2018	PERMIT RESPONSE
05	11.2018	GMP SET
07	03.2018	IFC SET

SEAL

KEYPLAN

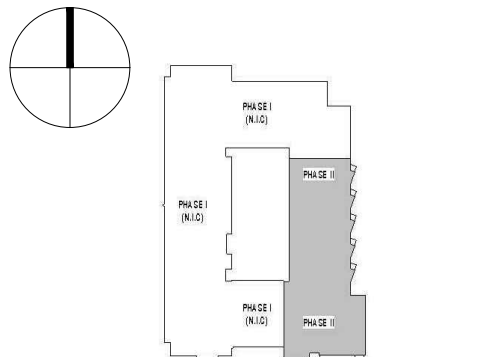

©2018 SK+I Architectural Design Group, LLC
THIS PROJECT IS PROTECTED BY COPYRIGHT
LAW AND INTERNATIONAL TREATIES

DRAWING TITLE

PLANT SCHEDULE

DATE 07.03.2018

SCALE 1"=10'

L012