

| NO.      | DATE | REVISION       |
|----------|------|----------------|
| 05/10/17 |      | REVISED PAVING |
|          |      | APPROVAL       |

PAVING PLAN 01

CRESCENT BISHOP ARTS  
 PHASE 1

CRESCENT COMMUNITIES

DRAWN BY: STANTEC  
 DESIGNED BY: RJJ  
 QA/QC: STANTEC  
 PROJECT NO.: 2222-10029

SHEET  
**C6.1**  
 311T-9191

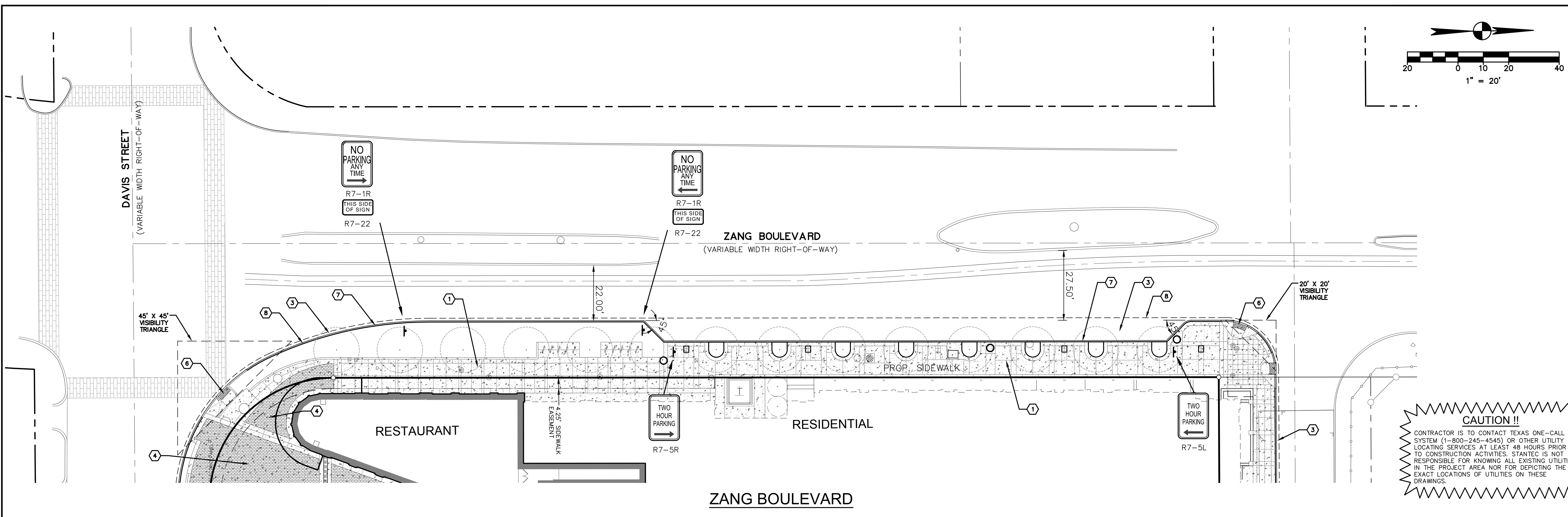
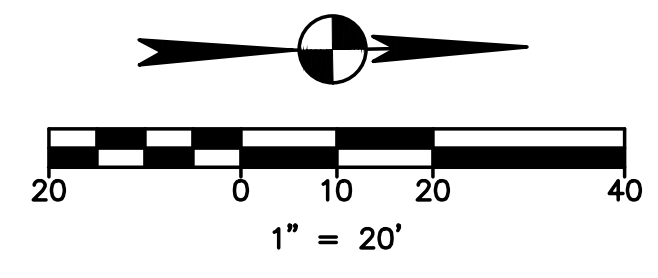

**CAUTION !!**  
 CONTRACTOR IS TO CONTACT TEXAS ONE-CALL SYSTEM (1-800-245-4545) OR OTHER UTILITY LOCATING SERVICES AT LEAST 48 HOURS PRIOR TO CONSTRUCTION ACTIVITIES. STANTEC IS NOT RESPONSIBLE FOR KNOWING ALL EXISTING UTILITIES IN THE PROJECT AREA NOR FOR DEPICTING THE EXACT LOCATIONS OF UTILITIES ON THESE DRAWINGS.

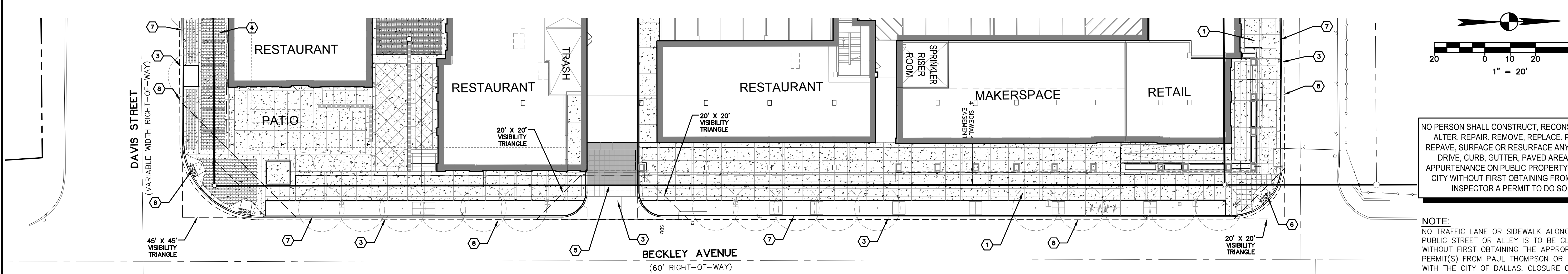
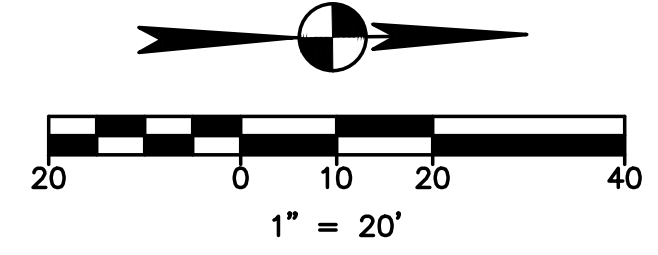

NO PERSON SHALL CONSTRUCT, RECONSTRUCT, ALTER, REPAIR, REMOVE, REPLACE, PAVE, REPAVE, SURFACE OR RESURFACE ANY WALK, DRIVE, CURB, GUTTER, PAVED AREA OR APPURTENANCE ON PUBLIC PROPERTY IN THE CITY WITHOUT FIRST OBTAINING FROM THE INSPECTOR A PERMIT TO DO SO

**NOTE:**  
 NO TRAFFIC LANE OR SIDEWALK ALONG ANY PUBLIC STREET OR ALLEY IS TO BE CLOSED WITHOUT FIRST OBTAINING THE APPROPRIATE PERMIT(S) FROM PAUL THOMPSON OR RUSSELL WITH THE CITY OF DALLAS. CLOSURE OF ANY TRAFFIC LANE MUST BE RESTRICTED TO THE HOURS OF 9:00 A.M. TO 3:30 P.M. WORKDAYS.

**NOTE:**  
 SAWCUT LINES SHOWN ON THE DESIGN PLANS FOR THE REMOVAL AND REPLACEMENT OF CONCRETE PAVEMENT, DRIVES, SLABS, SIDEWALKS, ETC. ARE FOR INFORMATIONAL PURPOSES ONLY. IF PAVEMENT IS MORE THAN 5 YEARS OLD, THE ENTIRE CONCRETE PANEL MUST BE REPLACED.

**NOTE:**  
 NON-STANDARD MATERIALS AGREEMENT  
 BY INSTRUMENT NO. 201600357744, D.R.D.C.T.

**CITY OF DALLAS WATER DEPARTMENT BENCHMARKS:**  
 CUT "X" SET AT THE SOUTHWEST CORNER OF CANTY STREET AND ZANG BOULEVARD, APPROXIMATELY 50-FEET EAST FROM THE CENTERLINE OF ZANG BOULEVARD, APPROXIMATELY 15-FEET SOUTH FROM THE CENTERLINE OF CANTY STREET.  
 ELEVATION = 500.33'  
 SQUARE CUT SET ON TOP OF CURB OF STORM SEWER INLET ALONG THE EAST SIDE OF ZANG BOULEVARD APPROXIMATELY 50-FEET EAST FROM THE CENTERLINE OF ZANG BOULEVARD, APPROXIMATELY 45-FEET SOUTH FROM THE CENTERLINE OF DAVIS STREET.  
 ELEVATION = 480.19'

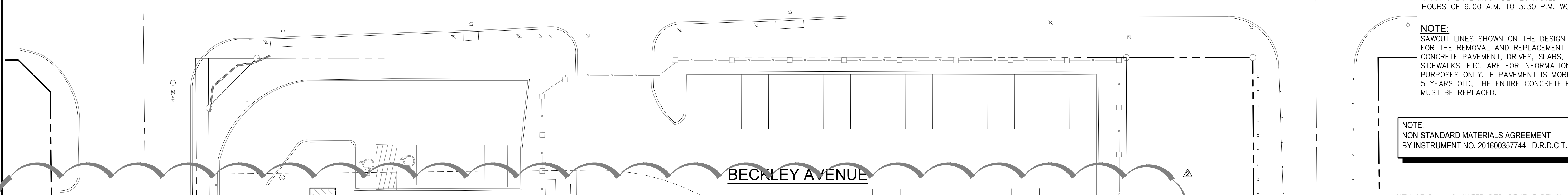

|  |   |   |   |
|--|---|---|---|
| <p><b>1 LIGHT DUTY PAVEMENT:</b><br/>         4" REINFORCED CONCRETE SIDEWALK FLATWORK (3000 PSI AT 28 DAYS) W/ #3 BARS @ 24" O.C.E.W. ON 6" COMPACTED SUBGRADE TO 95% AT OR ABOVE OPTIMUM MOISTURE CONTENT. (ASTM D 698)</p> <p><b>2 MEDIUM DUTY PAVEMENT: (PRIVATE)</b><br/>         6" 3000 PSI HAND FINISHED CONCRETE PAVT. W/ #3 BARS @ 24" O.C.E.W. ON 8"-6% LIME TREATED SUBGRADE COMPACTED TO 98% WITHIN THE RANGE OF -2% TO +4% PERCENTAGE POINTS ABOVE THE MIXTURES OPTIMUM MOISTURE CONTENT. (ASTM D 698)<br/>         ALTERNATE:<br/>         ADD 2" OF CONCRETE IN LIEU OF LIME STABILIZATION W/ #4 BARS @ 24" O.C.E.W.</p> | <p><b>3 HEAVY DUTY PAVEMENT: (PUBLIC)</b><br/>         8" 4500 PSI HAND FINISHED CONCRETE PAVT. W/ #3 BARS @ 24" O.C.E.W. ON 8"-6% LIME TREATED SUBGRADE COMPACTED TO 98% WITHIN THE RANGE OF -2% TO +4% PERCENTAGE POINTS ABOVE THE MIXTURES OPTIMUM MOISTURE CONTENT. (ASTM D 698)<br/>         ALTERNATE:<br/>         ADD 2" OF CONCRETE IN LIEU OF LIME STABILIZATION W/ #4 BARS @ 24" O.C.E.W.</p> <p><b>4 BRICK PAVERS OVER LIGHT DUTY PAVEMENT:</b><br/>         SEE DETAIL C6.3.9<br/>         4" REINFORCED CONCRETE SIDEWALK FLATWORK (3000 PSI AT 28 DAYS) W/ #3 BARS @ 24" O.C.E.W. ON 6" COMPACTED SUBGRADE TO 95% AT OR ABOVE OPTIMUM MOISTURE CONTENT. (ASTM D 698)</p> | <p><b>5 SAWCUT JOINTS ON HEAVY DUTY PAVEMENT: (PUBLIC)</b><br/>         SEE DETAIL C6.3.9<br/>         8" 4500 PSI HAND FINISHED CONCRETE PAVT. W/ #3 BARS @ 24" O.C.E.W. ON 8"-6% LIME TREATED SUBGRADE COMPACTED TO 98% WITHIN THE RANGE OF -2% TO +4% PERCENTAGE POINTS ABOVE THE MIXTURES OPTIMUM MOISTURE CONTENT. (ASTM D 698)<br/>         ALTERNATE:<br/>         ADD 2" OF CONCRETE IN LIEU OF LIME STABILIZATION W/ #4 BARS @ 24" O.C.E.W.</p> <p><b>6 RED COLORED TRUNCATED DOME PAVERS:</b><br/>         PER ADA SECTION 4.29.2</p> | <p><b>LEGEND</b></p> <p>— EXISTING CURB</p> <p>— PROPOSED CURB</p> <p>--- SAWCUT, REMOVE AND DISPOSE OF EXISTING CURB, GUTTER &amp; PAVEMENT</p> <p>— PROPOSED RETAINING WALL</p> |
|--|---|---|---|