

# CRESCENT COMMUNITIES

## NoDa RETAIL BUILDING

36TH STREET, CHARLOTTE, NORTH CAROLINA

THIS DRAWING AND THE DESIGN SHOWN IS THE PROPERTY OF THE ARCHITECT AND MAY NOT BE REPRODUCED, COPIED OR USED WITHOUT WRITTEN PERMISSION. COPYRIGHT © 2014, INTEC GROUP, INC.

Thursday, April 27, 2017 | 4:38pm | I:\\_2017\1017053\CAD\Construction Documents\DDI\_COVER SHEET.dwg

**DEVELOPER**

**CRESCENT COMMUNITIES**  
 227 WEST TRADE STREET  
 SUITE 100  
 CHARLOTTE, NC 28202  
 980.321.6194  
**CONTACT:**  
 KATIE MALOUMIAN

**LANDSCAPE ARCH./  
 CIVIL ENGINEER**

**LANDDESIGN, INC.**  
 223 NORTH GRAHAM ST.  
 CHARLOTTE, NC 28202  
 704.333.0325  
**CONTACT:**  
 ROB KEIDEL

**ARCHITECT**

**INTEC GROUP, INC.**  
 214 W. TREMONT AVENUE  
 SUITE 301  
 CHARLOTTE, NC 28203  
 704.372.7910  
**CONTACT:**  
 GREG GRUENEICH

Sheet Index:	DESIGN DEV. SET
<b>Chapter 1 - GENERAL</b>	
C1.00 - COVER SHEET	4/26/2017
<b>Chapter 2 - DEMOLITION &amp; EROSION CONTROL</b>	
C2.00 - DEMOLITION PLAN	-
C2.10 - EROSION CONTROL PLAN	-
C2.20 - EROSION CONTROL DETAILS	-
<b>Chapter 3 - SITE &amp; PAVING</b>	
C3.00 - OVERALL LAYOUT PLAN	4/26/2017
C3.01 - LAYOUT ENLARGEMENT PLAN	4/26/2017
C3.10 - OVERALL MATERIALS PLAN	4/26/2017
C3.11 - PAVING & MATERIALS ENLARGEMENT PLAN	4/26/2017
C3.20 - OVERALL LIGHTING PLAN	-
<b>Chapter 4 - SITE &amp; PAVING DETAILS</b>	
C4.00-C4.03 - SITE DETAILS	4/26/2017
<b>Chapter 5 - GRADING</b>	
C5.00 - OVERALL GRADING PLAN	4/26/2017
C5.01 - GRADING ENLARGEMENT PLAN	4/26/2017
C5.10 - GRADING NOTES & DETAILS	4/26/2017
<b>Chapter 6 - UTILITIES</b>	
C6.00 - UTILITY PLAN	4/26/2017
C6.10 - UTILITY DETAILS	4/26/2017
<b>Chapter 7 - STORMWATER</b>	
C7.00 - STORM DRAINAGE PLAN	4/26/2017
C7.10 - STORM DRAINAGE DETAILS	-
<b>Chapter 8 - PLANTING</b>	
C8.00 - REQUIRED PLANTING PLAN	4/26/2017
C8.10 - FINAL PLANTING PLAN	-
C8.20 - PLANTING DETAILS	4/26/2017
C8.22 - PLANTING NOTES	4/26/2017
<b>Chapter 9 - SITE SECTIONS &amp; PERSPECTIVES</b>	
C9.00 - SITE SECTIONS	-
C9.10 - SITE PERSPECTIVES	-
<b>Chapter 10 - ARCHITECTURE ELEVATIONS</b>	
A1.00 - EXTERIOR ELEVATIONS	-

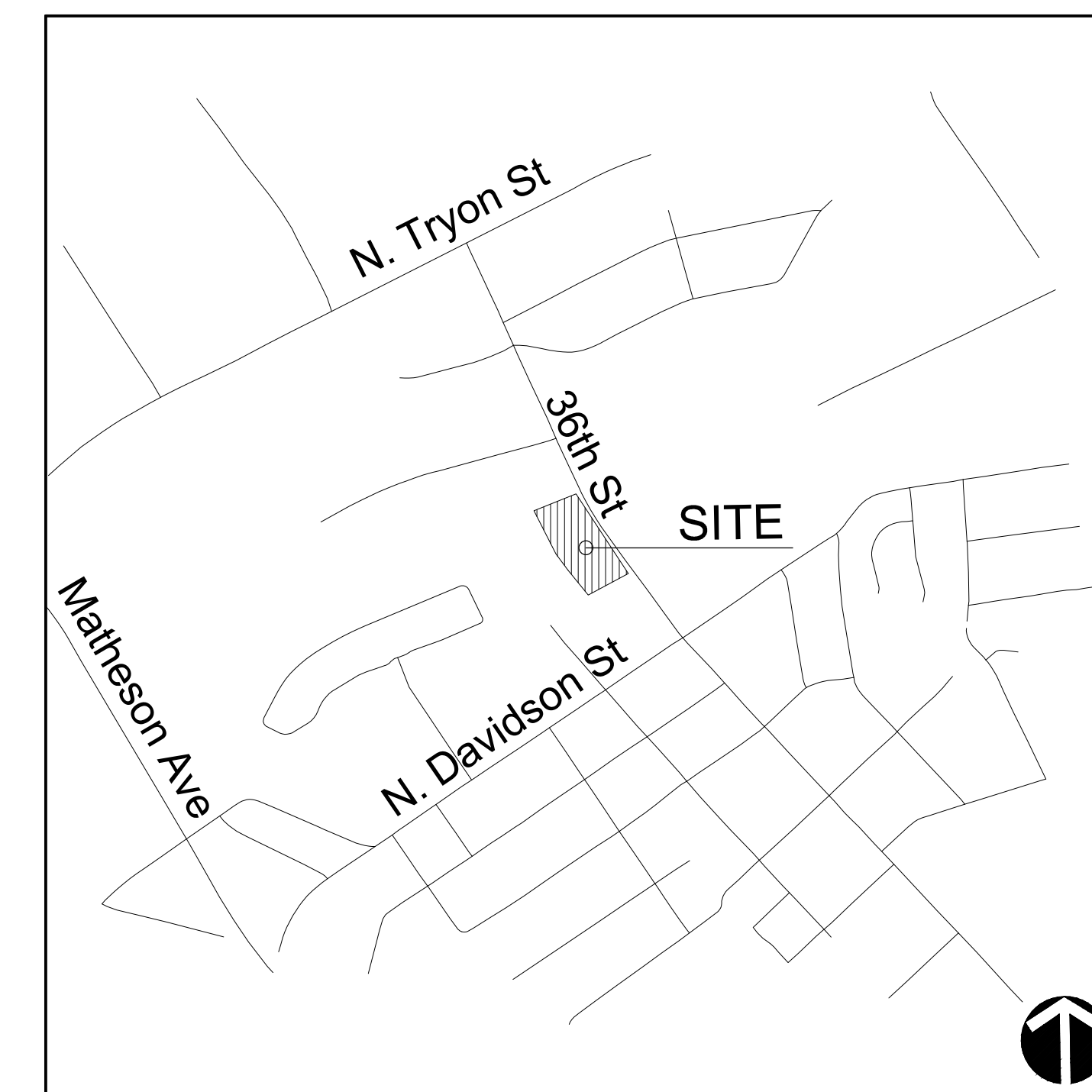

VICINITY MAP  
 NOT TO SCALE



INTEC Group, Inc.  
 214 W. TREMONT AVENUE  
 SUITE 301  
 CHARLOTTE, NC 28203  
 P: 704.372.7910  
 www.intecgroup.net



ASANA  
 PARTNERS



www.LandDesign.com  
 223 N Graham Street  
 Charlotte, NC 28202 NC  
 P. 704.333.0325  
 F. 704.332.3246  
 Engineering Firm License # C-0658

PROJECT

CRESCENT COMMUNITIES  
 36TH STREET, CHARLOTTE, NC  
 NoDa RETAIL BUILDING

STAMP

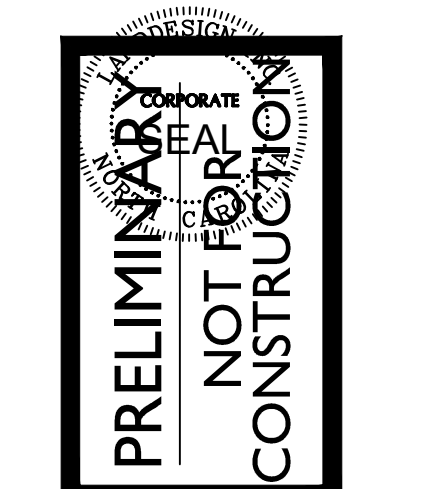

DRAWING LOG

ISSUE:	DESIGN DEVELOPMENT
DATE:	4/26/17
ISSUE:	(2)
DATE:	(DATE 2)
ISSUE:	(3)
DATE:	(DATE 3)
ISSUE:	(4)
DATE:	(DATE 4)
ISSUE:	(5)
DATE:	(DATE 5)
ISSUE:	(6)
DATE:	(DATE 6)

SHEET INFORMATION  
 DATE OF DRAWING: 4/26/17  
 DRAWN BY: -  
 JOB NUMBER: 119201

COVER SHEET

C1.00