

MATCH LINE SEE SHEET 7

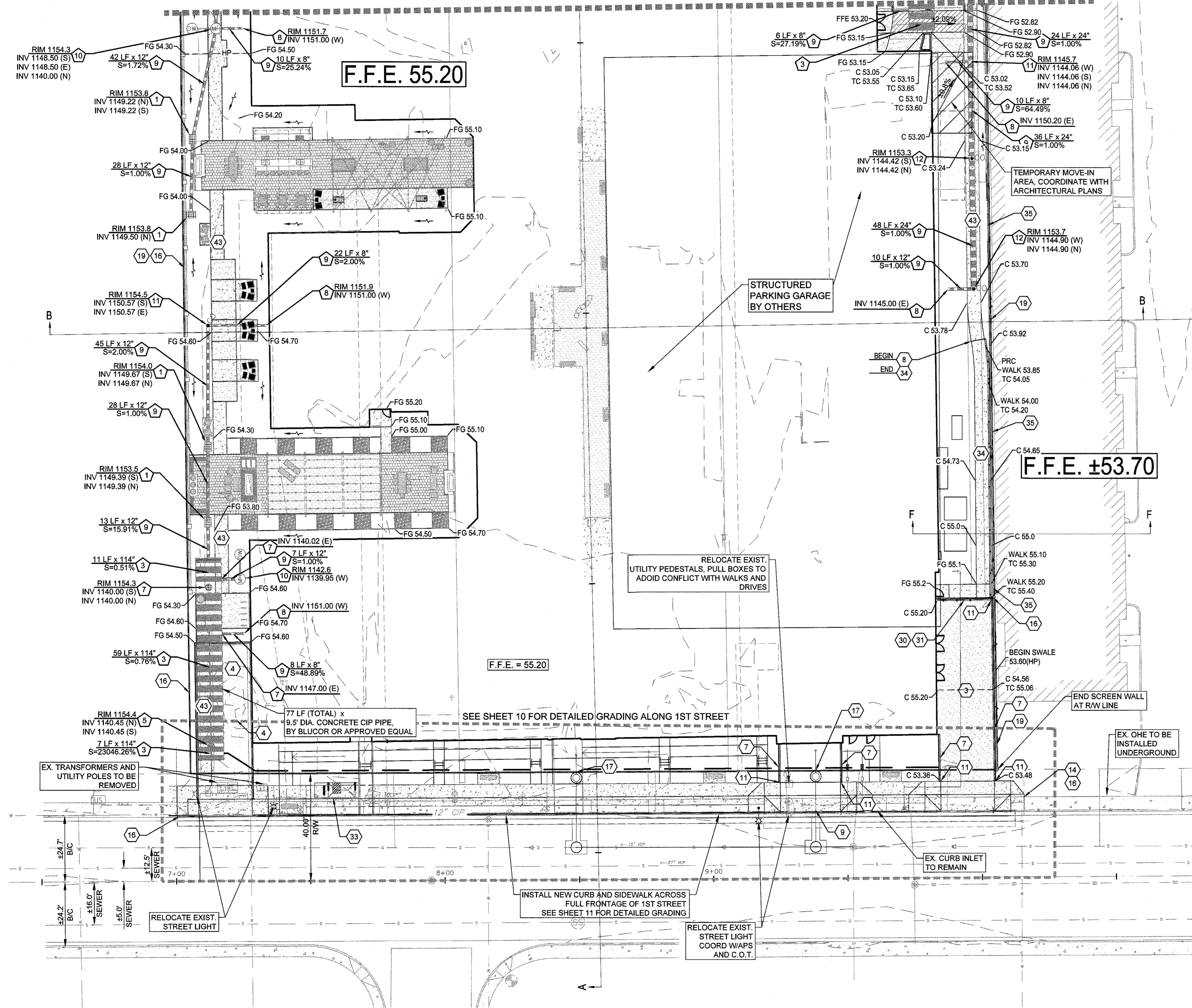

STORM DRAIN CONSTRUCTION NOTES

- 1 INSTALL CATCH BASIN TYPE 'F' PER M.A.G. STD. DTL. 535.
- 3 INSTALL 9.5"Ø C.I.P. STORM DRAIN PIPE PER M.A.G. SPEC 620. TRENCH AND BACKFILL PER M.A.G. SPEC. 601.
- 5 INSTALL 48"Ø MANHOLE SHAFT WITH 30" FRAME AND GRATE COVER PER M.A.G. STD. DTL. 424-2 AND 522 SECTION B-B. INSTALL CONCRETE COLLAR PER C.O.T. STD. DTL. T-446.
- 7 CONNECT TO STORAGE PIPE. SEE DETAIL SHEET.
- 8 CONNECT TO ROOF LEADER DISCHARGE PIPING. SEE MEP PLANS FOR CONTINUATION.
- 9 INSTALL PVC (SDR 35) PIPE. LENGTH, SLOPE AND SIZE PER PLAN.
- 10 INSTALL MAXWELL PLUS DRYWELL AS DISTRIBUTED BY TORRENT RESOURCES (OR APPROVED EQUAL). SEE DETAIL SHEET FOR ADDITIONAL INFORMATION.
- 11 INSTALL WYE CONNECTION. INVERTS PER PLAN.
- 12 INSTALL CLEANOUT PER M.A.G. STD. DTL. 441, MODIFY FOR PVC PIPE, SIZE TO MATCH PIPE, MODIFY COVER TO NYOPLAST 12" PEDESTRIAN GRATE PER MANUFACTURER SPECIFICATIONS. INSTALL GRATES SQUARE TO FLAT WORK.

PAVING AND GRADING CONSTRUCTION NOTES

- 3 INSTALL CONCRETE PAVING (7" THICK) OVER SUBGRADE PREPARED PER GEOTECHNICAL REPORT REQUIREMENTS. FINISH, COLOR AND SCORING PER HARDSCAPE PLANS.
- 4 INSTALL STABILIZED DECOMPOSED GRANITE SURFACE OVER 6" ABC OVER 12" COMPACTED SUBGRADE PER GEOTECHNICAL REPORT. THICKNESS, FINISH, COLOR AND GRADATION PER HARDSCAPE PLANS.
- 5 INSTALL 6" CURB AND GUTTER PER M.A.G. STD. DTL. 220-1, TYPE 'A'.
- 7 INSTALL 6" SINGLE CURB PER M.A.G. STD. DTL. 222, TYPE A.
- 8 INSTALL SIDEWALK 5' WIDTH PER C.O.T. STD. DTL. T-345. FINISH, COLOR AND SCORING PER HARDSCAPE PLANS.
- 9 INSTALL DRIVEWAY PER C.O.T. STD. DTL. T-320.
- 11 TRANSITION CURB FROM 6" TO FLUSH AS NOTED.
- 14 REMOVE EXISTING SIDEWALK, CURB AND GUTTER TO NEAREST CONSTRUCTION JOINT AS NECESSARY TO FACILITATE NEW CONSTRUCTION.
- 15 INSTALL CURB TERMINATION PER M.A.G. STD. DTL. 222.
- 16 MATCH FINISH GRADE TO EXIST. GRADE
- 17 ADJUST GRATE/MANHOLE RIM PER M.A.G. STD. DTL. 422.
- 19 INSTALL SCREEN WALL, SEE LANDSCAPE PLANS FOR DETAILS.
- 20 INSTALL RIBBON CURB PER M.A.G. STD. DTL. 220-1, TYPE B, MODIFIED FOR 6" WIDTH.
- 31 INSTALL BOLLARD PER M.A.G. STD. DTL. 140, TYPE 1. SEE LS PLANS FOR DETAILS.
- 33 INSTALL BUS SHELTER PER C.O.T. STD. DTL. T-654 TYPE A. (5.5x 16.5')
- 34 INSTALL WALK WITH INTEGRAL SAFETY RAIL AND RETAINING WALL. SEE DETAIL SHEET 10.
- 35 INSTALL CONCRETE LINED SWALE. SEE DETAIL SHEET 10.
- 43 INSTALL SIDEWALK 5' WIDE PER C.O.T. STD. DTL. T-345

NOTE TO CONTRACTOR:

"ALL UNDERGROUND CABLE, PIPE, AND CONDUITS SHALL BE DETECTIBLE (METALLIC) OR HAVE A DETECTIBLE UNDERGROUND LOCATION DEVICE INSTALLED WITH IT. THE RECOMMENDED DETECTIBLE UNDERGROUND LOCATION DEVICE IS A #18 OR LARGER AT 8" O.C. IT SHALL HAVE 12" OF TRACER WIRE ACCESSIBLE ABOVE GRADE AT ANY ABOVE GRADE TERMINATION".

ALL EXIST. UTILITIES, PULL BOXES PEDESTAL, ETC. SHALL BE RELOCATED OUTSIDE OF DRIVEWAY AND SIDEWALKS.

AFTER DEMOLITION OF THE EXIST. ON-SITE BUILDING, THE CONTRACTOR SHALL CONTACT THE ENGINEER OF RECORD FOR REVIEW AND PLACEMENT OF THE PROPOSED RETAINING WALL.

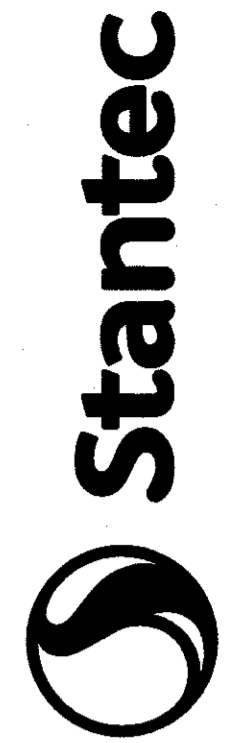
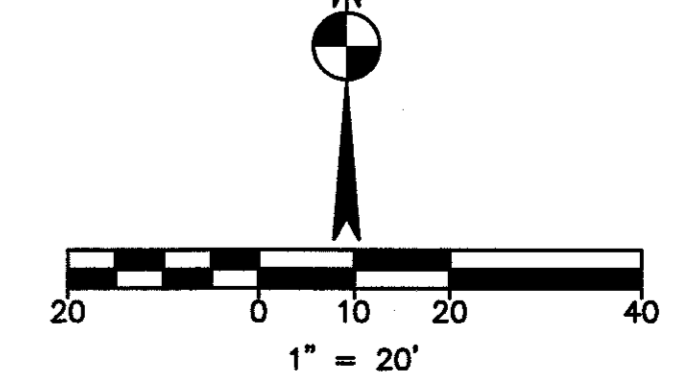

821 South 48th Street
Phoenix, AZ 85044-5335
www.stantec.com

NOTICE OF EXTENDED CERTIFICATION AND APPROVAL PERIOD PROVISION
THIS CONTRACT ALLOWS THE OWNER TO CERTIFY AND APPROVE BILLINGS AND ESTIMATES FOR PROGRESS PAYMENTS WITHIN 25 DAYS AFTER THE BILLINGS AND ESTIMATES ARE RECEIVED FROM THE CONTRACTOR, FOR RELEASE OF RETENTION WITHIN 45 DAYS AFTER THE BILLINGS AND ESTIMATES ARE RECEIVED FROM THE CONTRACTOR AND FOR FINAL PAYMENT WITHIN 45 DAYS AFTER THE BILLINGS AND ESTIMATES ARE RECEIVED FROM THE CONTRACTOR.

NOTICE OF EXTENDED PAYMENT PROVISION
THIS CONTRACT ALLOWS THE OWNER TO MAKE PAYMENT WITHIN 20 DAYS AFTER CERTIFICATION AND APPROVAL OF BILLINGS AND ESTIMATES FOR PROGRESS PAYMENTS, WITHIN 45 DAYS AFTER CERTIFICATION AND APPROVAL OF BILLINGS AND ESTIMATES FOR RELEASE OF RETENTION AND WITHIN 45 DAYS AFTER CERTIFICATION AND APPROVAL OF BILLINGS AND ESTIMATES FOR FINAL PAYMENT.

Client/Project
CRESCENT COMMUNITIES

CRESCENT RIO
801 WEST 1ST STREET, TEMPE, AZ

Title
GRADING AND DRAINAGE PLAN

EN170054

700 W. 1ST STREET

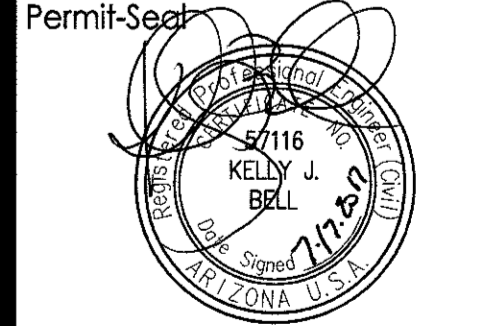

Permit-See
EXPIRES 03-31-2021
Project Number: 2220-10676
File Name: 100956028gd07.dwg
Dwn. Chkd. Dsgn. YJMM/DD
Drawing No.
Revision Sheet