

1. INSTALL 8" SLOTTED DRAIN PIPE PER ADS DURASLOT PIPE. (OR APPROVED EQUAL)
2. N-12 FOR UNDERSIDEWALK AND GROUND COVER AREAS
3. H-25 FOR UNDER DRIVEWAYS

SLOTTED DRAIN DETAIL SECTION H-H
LOOKING WEST
N.T.S.

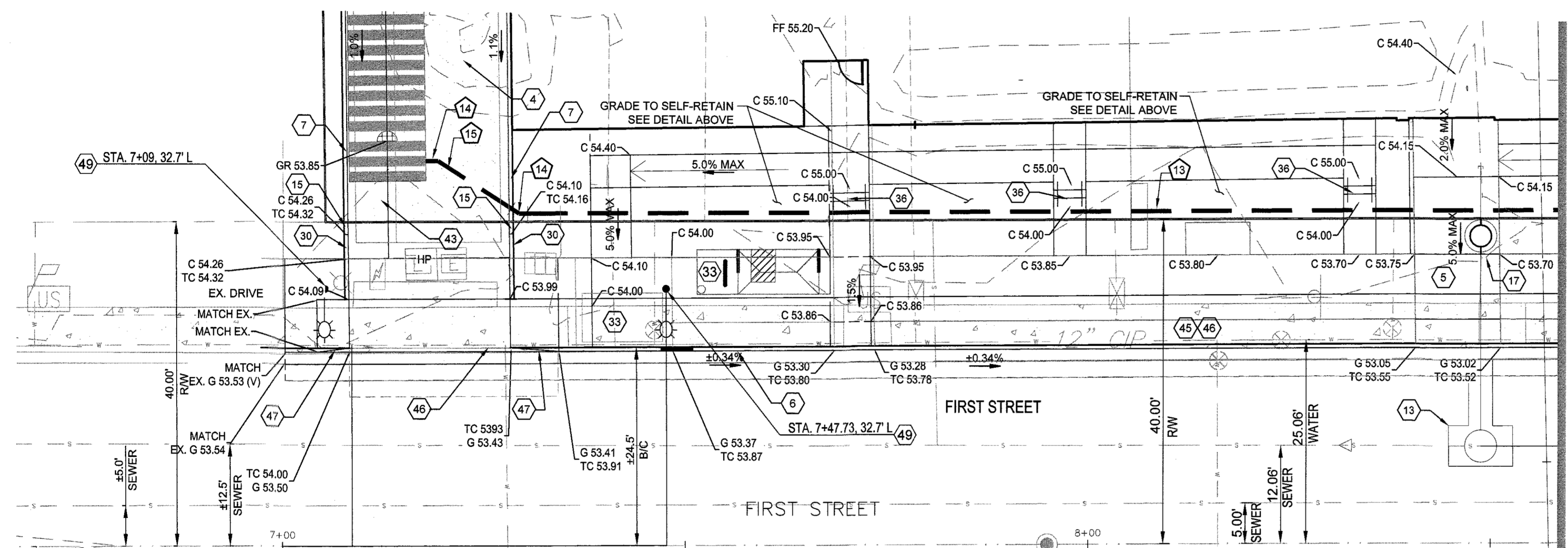

FIRST STREET GRADING DETAIL
1"=10'

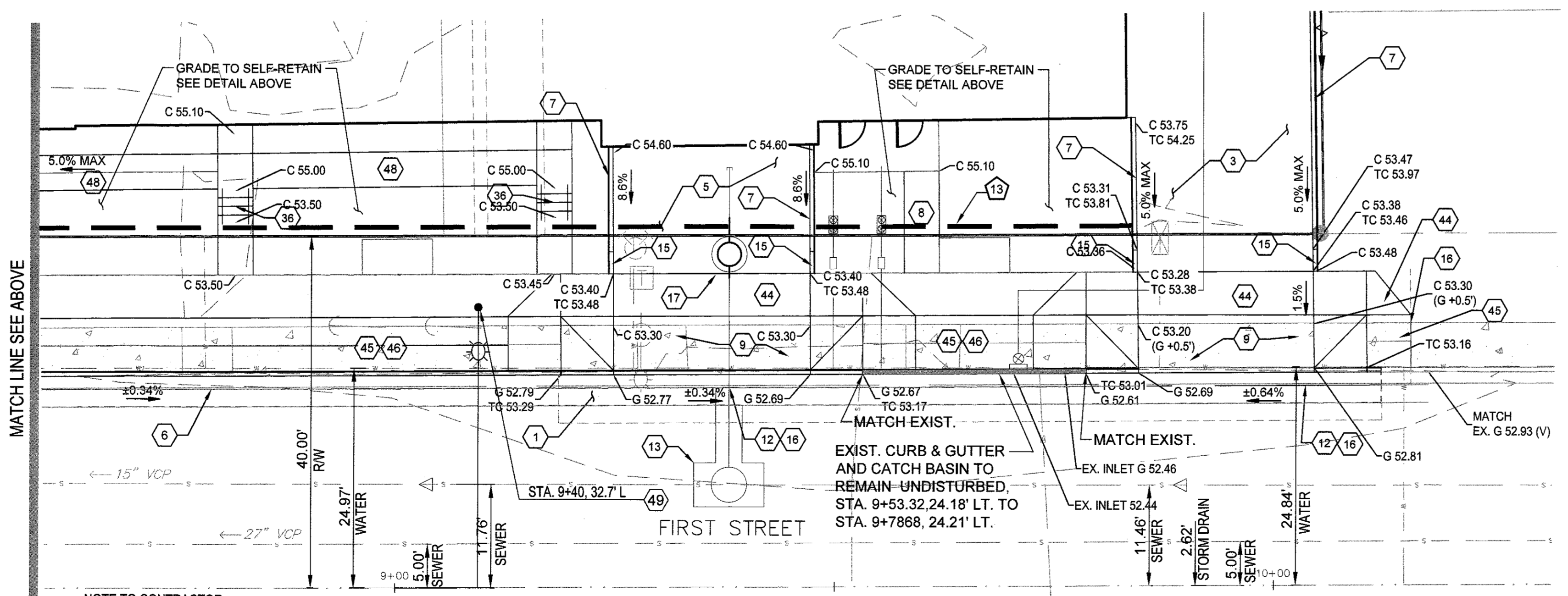

FIRST STREET GRADING DETAIL
1"=10'

NOTE TO CONTRACTOR:
"ALL UNDERGROUND CABLE, PIPE, AND CONDUITS SHALL BE DETECTIBLE (METALLIC) OR HAVE A DETECTIBLE UNDERGROUND LOCATION DEVICE INSTALLED WITH IT. THE RECOMMENDED DETECTIBLE UNDERGROUND LOCATION DEVICE IS A #18 OR LARGER AT 8" O.C. IT SHALL HAVE 12" OF TRACER WIRE ACCESSIBLE ABOVE GRADE AT ANY ABOVE GRADE TERMINATION."

NOTE TO CONTRACTOR:
ALL EXIST. UTILITIES, PULL BOXES PEDESTAL, ETC. SHALL BE RELOCATED OUTSIDE OF DRIVEWAY AND SIDEWALKS.

STORM DRAIN CONSTRUCTION NOTES

13. INSTALL 8" SLOTTED DRAIN PER ADS DURASLOT PIPE (OR APPROVED EQUAL)
N-12 FOR UNDER SIDEWALK & GROUND COVER
H-25 FOR UNDER DRIVEWAYS (SEE SLOTTED DRAIN PIPE DETAIL ON THIS SHEET.)
15. INSTALL 8"x 45" BEND FOR DURASLOT H-25 PIPE OR APPROVED EQUAL.
16. INSTALL 25 LF 8" SOLID DURASLOT H-25 PIPE
17. INSTALL 8" SLOTTED DRAIN PER ADS DURASLOT PIPE (OR APPROVED EQUAL)

PAVING AND GRADING CONSTRUCTION NOTES

1. INSTALL HEAVY DUTY PAVING (3" AC OVER 8" ABC) PER GEOTECHNICAL REPORT PREPARED BY SPEEDIE AND ASSOCIATES DATED MARCH 14, 2017 WITH PROJECT NUMBER 1508985A, UNLESS OTHERWISE SPECIFIED BY HARDSCAPE PLANS. FINISH, COLOR AND SCORING PER HARDSCAPE PLANS. ANY ALTERNATES ARE TO BE APPROVED BY GEOTECHNICAL ENGINEER.
3. INSTALL CONCRETE PAVING (7" THICK) OVER SUBGRADE PREPARED PER GEOTECHNICAL REPORT REQUIREMENTS.
4. INSTALL STABILIZED DECOMPOSED GRANITE SURFACE OVER 6" ABC OVER 12" COMPACTED SUBGRADE PER GEOTECHNICAL REPORT. THICKNESS, FINISH, COLOR AND GRADATION PER HARDSCAPE PLANS.
5. INSTALL PRECAST CONCRETE PAVERS PER LANDSCAPE PLANS.
6. INSTALL 6" CURB AND GUTTER PER M.A.G. STD. DTL. 220-1, TYPE 'A'.
7. INSTALL 6" SINGLE CURB PER M.A.G. STD. DTL. 222, TYPE A.
8. INSTALL SIDEWALK (8" MIN. WIDTH IN R/W) PER C.O.T. STD. DTL. T-345. FINISH, COLOR AND SCORING PER HARDSCAPE PLANS.
9. INSTALL DRIVEWAY PER C.O.T. STD. DTL. T-320.
12. SAWCUT AND REMOVE 2' MIN. EXISTING ASPHALT PAVING AS NECESSARY TO FACILITATE NEW CONSTRUCTION. REPLACE PER C.O.T. STD. DTL. T-313.
13. SAWCUT AND REMOVE 2' MIN. EXISTING ASPHALT PAVING AS NECESSARY TO FACILITATE NEW CONSTRUCTION. REPLACE PER M.A.G. STD. DTL. 200-1, 'T-TOP'. ADJUST MANHOLE FRAME AND COVER PER M.A.G. STD. DTL. 422.
15. INSTALL CURB TERMINATION PER M.A.G. STD. DTL. 222.
16. MATCH FINISH GRADE TO EXIST. GRADE
17. ADJUST GRATE/MANHOLE RIM PER M.A.G. STD. DTL. 422.
30. INSTALL RIBBON CURB PER M.A.G. STD. DTL. 220-1, TYPE 'B', MODIFIED FOR 6" WIDTH.
33. INSTALL BUS SHELTER PER C.O.T. STD. DTL. T-654, TYPE A. (5.5' x 16.5' (SHT. 9 OR DETAILS)
36. INSTALL STEPS AND HANDRAIL. SEE LANDSCAPE PLANS FOR DETAILS.
37. REMOVE EXIST. CURB & GUTTER AND INSTALL VALLEY GUTTER PER M.A.G. STD. DTL. 240 MODIFIED TO 3' WIDE.
44. INSTALL SIDEWALK 5' WIDE PER C.O.T. STD. DTL. T-345.
45. INSTALL SIDEWALK 6' WIDE PER C.O.T. STD. DTL. T-345.
46. REMOVE ALL EXIST. 5' WIDE SIDEWALK ALONG 1st STREET.
47. INSTALL MOUNTABLE CURB & GUTTER PER M.A.G. STD. DTL. 220-2 TYPE F.
48. INSTALL A SIDEWALK 4' WIDE PER C.O.T. STD. DTL. T-345.

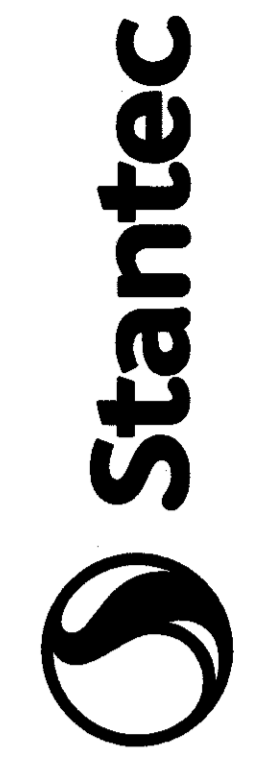
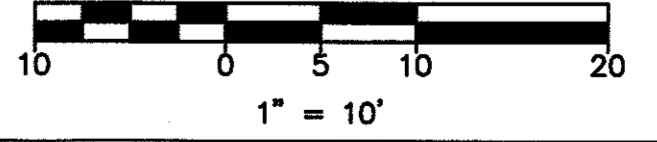
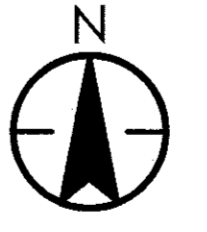
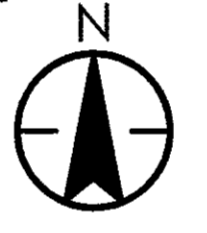

8211 South 46th Street
Phoenix, AZ 85044-5335
www.stantec.com

The Contractor shall verify and be responsible for all dimensions. DO NOT scale the drawing - any errors or omissions shall be reported to Stantec without delay. This drawing is the property of Stantec and shall not be reproduced, stored in a retrieval system, or used for any purpose other than that authorized by Stantec, its subsidiaries, or affiliates.

NOTICE OF EXTENDED CERTIFICATION AND APPROVAL PERIOD PROVISION
THIS CONTRACT ALLONS THE OWNER TO CERTIFY AND APPROVE ALL ITEMS FOR PROGRESS PAYMENTS WITHIN 25 DAYS AFTER THE BILLINGS AND ESTIMATES ARE RECEIVED FROM THE CONTRACTOR. FOR RELEASE OF RETENTION WITHIN 45 DAYS AFTER THE BILLINGS AND ESTIMATES ARE RECEIVED FROM THE CONTRACTOR AND FOR FINAL PAYMENT WITHIN 45 DAYS AFTER THE BILLINGS AND ESTIMATES ARE RECEIVED FROM THE CONTRACTOR.

NOTICE OF EXTENDED PAYMENT PROVISION
THIS CONTRACT ALLONS THE OWNER TO MAKE PAYMENT WITHIN 20 DAYS AFTER CERTIFICATION AND APPROVAL OF BILLINGS AND ESTIMATES FOR PROGRESS PAYMENTS, WITHIN 45 DAYS AFTER CERTIFICATION AND APPROVAL OF BILLINGS AND ESTIMATES FOR RELEASE OF RETENTION AND WITHIN 45 DAYS AFTER CERTIFICATION AND APPROVAL OF BILLINGS AND ESTIMATES FOR FINAL PAYMENT.

Client/Project
CRESCENT COMMUNITIES
CRESCENT RIO
801 WEST 1ST STREET, TEMPE, AZ

Title
GRADING AND DRAINAGE PLAN
EN170054

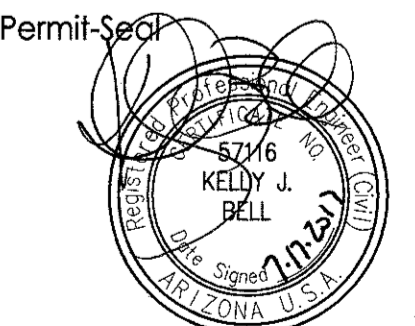

Permit Seal
EXPIRES 03-31-2021
Project Number: 2220-10676
File Name: 102756028gd10.dwg
Dwn. Chkd. Dgn. YY.MM.DD
Drawing No.
Revision Sheet

700 W. 1ST STREET

EN170054

DS160372