

DEMOLITION NOTES

1. DEMOLISH ALL HATCHED LIGHTING, JUNCTION BOXES FOR DECOR LIGHTING, OUTLETS FOR DECOR SIGNAGE AND ASSOCIATED WIRING COMPLETE UNLESS OTHERWISE NOTED.
2. DISCONNECT AND REMOVE ALL LIGHTING CONTROLS, SWITCHES, TIMERS, OCCUPANCY SENSORS, ETC. ASSOCIATED WITH DEMOLISHED LIGHTING
3. E.C. SHALL FIELD VERIFY EXACT LOCATIONS AND QUANTITY OF LIGHTING TO BE DEMOLISHED PRIOR TO BID.

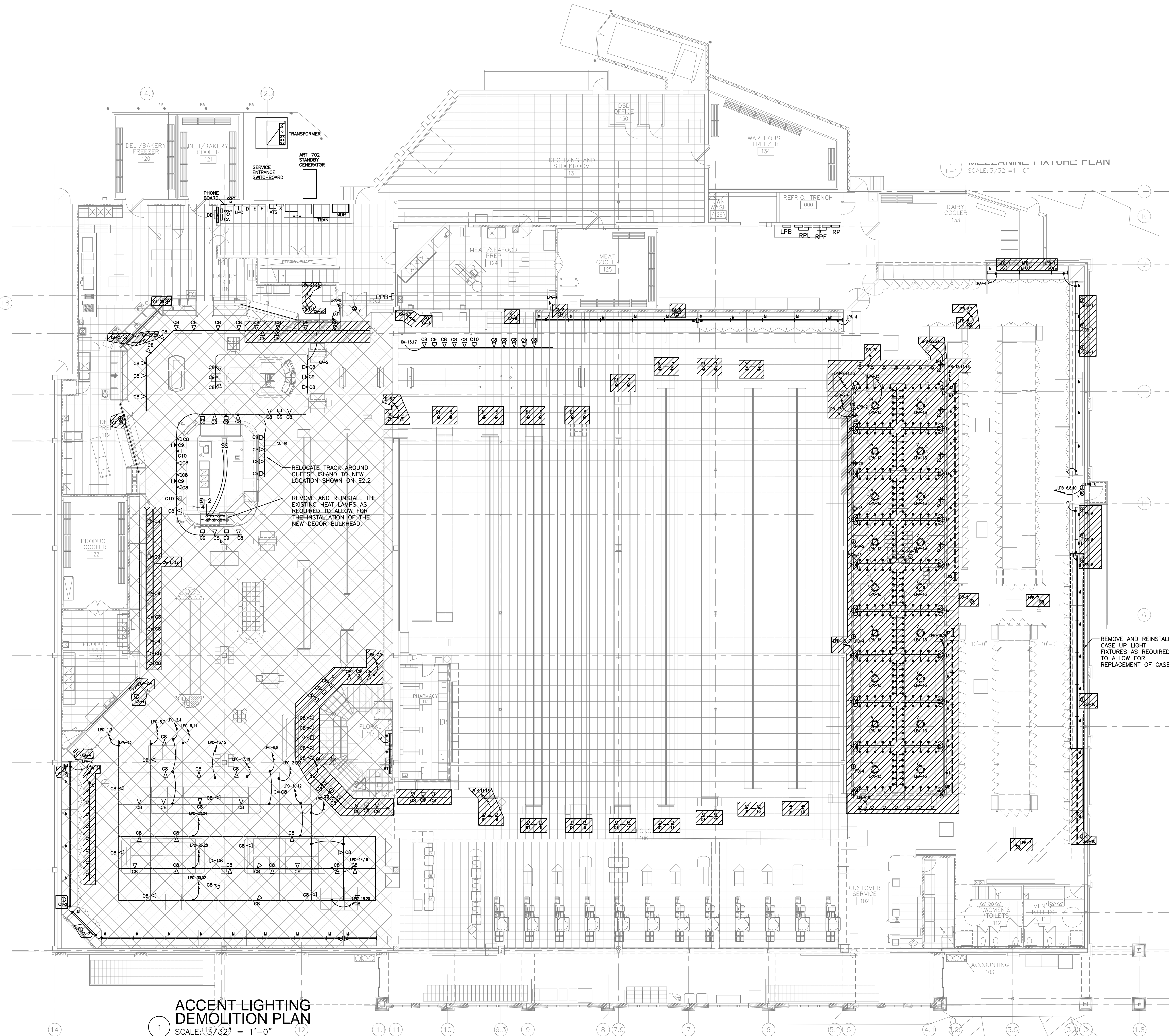

ACCENT LIGHTING DEMOLITION PLAN
SCALE: 3/32" = 1'-0"

8/24/2016 2:07:21 PM

Harris Teeter
Your Neighborhood Food and Pharmacy

NOTE: THIS DOCUMENT MAY HAVE BEEN ELECTRONICALLY TRANSMITTED. IF UNSIGNED, IT CANNOT BE FILED FOR PUBLIC RECORD. PUBLIC RECORD FILINGS REQUIRE SIGNED AND SEALED DOCUMENTS.



Electronically Signed By:
Robert K. Stacy
Using IdemTrust Certificate
2016.08.24 14:59:50-0400

HARRIS TEETER
STORE # 208
COTSWOLD SHOPPING CENTER
CHARLOTTE, NC

PROJECT MANAGER
ROBERT K. STACY
JOB NO.
15-H1208-02
DR. BY:

REVISIONS	Date
No.	Date
No.	Date
No.	Date
No.	Date
No.	Date
No.	Date
No.	Date
No.	Date
No.	Date
No.	Date
No.	Date

DRAWING NAME
ACCENT LIGHTING DEMOLITION PLAN

SHEET NO.
E2.0A
ISSUE DATE: 08.23.16