

Above Finished Floor Heights for Decor Items

- Beer Cooler Wall Clouds**
Top of Clouds: 13'
- Bread Canopy**
Bottom of Bulkhead: 9'
Top of Clouds: 11'-3"
- Checkout Canopy**
Bottom of Bulkhead: 11'
Top of Clouds: 12'-5"
- Cheese Canopy**
Bottom of Bulkhead: 10'-2"
Top of Clouds: 12'
- Dairy Cooler Wall Clouds**
Top of Clouds: 13'
- Deli-Bakery Bulkhead w/ Clouds**
Bottom of Bulkhead: 8'
Top of Clouds: 13'
- Front Wall Clouds**
Top of Clouds: 13'
- Main Rear Sales Area Wall Clouds**
Top of Clouds: 13'
- Produce Area Wall Clouds**
Top of Clouds: 13'
- Wine Canopy**
Bottom of Main Beams: 9'
Top of Cross Beams: 10'-6"
- USCAN WALLS** (2)

Note: All clouds are a nominal one foot in height.

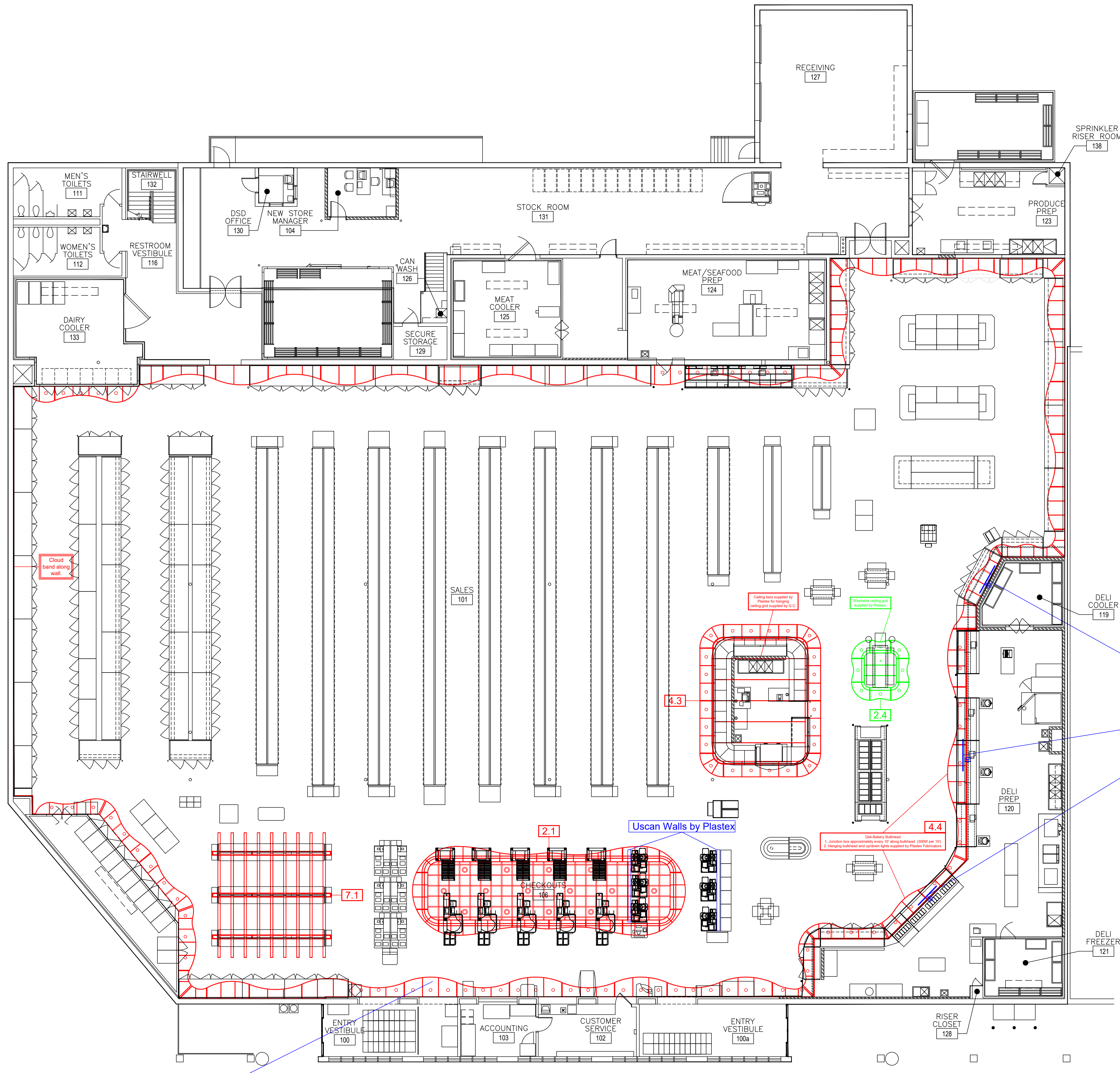

***Deli-Bakery Lower Lights**
 - Change lightboxes to LED, will need power disconnect and reconnect

- Note:**
- Existing items marked in RED
 - New items marked in BLUE
 - Relocated items marked in GREEN
 - Removed items in MAGENTA

Partial cloud bulb/fixture replacement as needed. May need power disconnect/reconnect.

Drawn by: Plastex
 Scale: 3/32" = 1'-0"

Contact Michael Lippard with Plastex Fabricators @ 704-393-4040 for bulkhead and canopy pricing.

Job Description
 Revised Fixture Plan
 Harris Teeter 297
 Carrboro North Carolina

Sheet Description
 Decor Signage Plan

Sheet Number
D-1.0