

6/20/2011 8:53 PM L:\Projects\2011\Projects\11-4020 Harris Teeter Warehouse Pharmacy\11-4020 Harris Teeter Warehouse Pharmacy\11-4020.dwg C1.2 Autoturn 11/15/2011

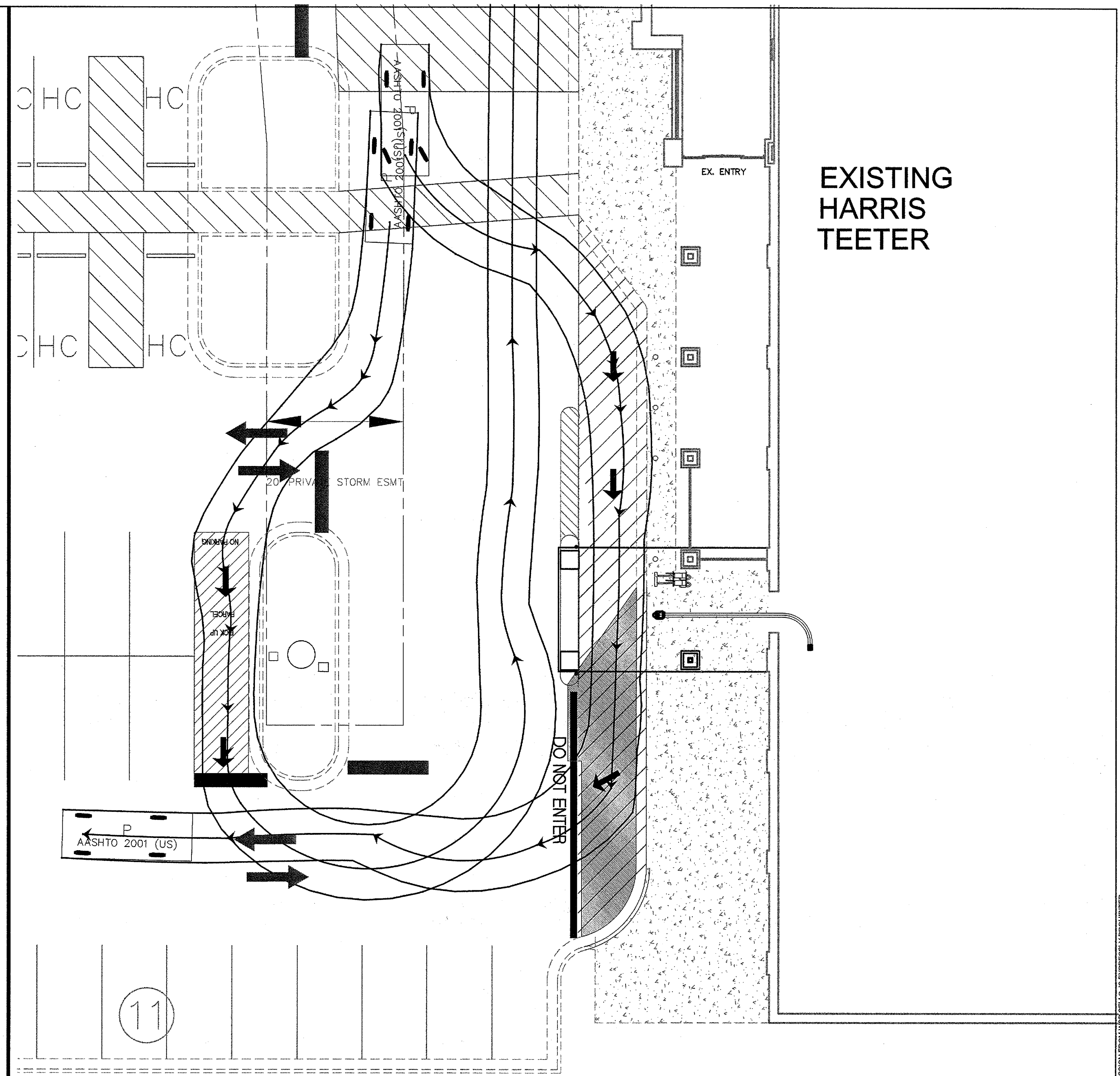

NOTES

THE REVISIONS PROPOSED FOR THE PHARMACY DRIVE THRU DO NOT ADD ANY IMPERVIOUS AREA TO THE PROJECT SITE. THE AREA THAT IS BEING REVISED IS ALREADY IMPERVIOUS AND THEREFORE THERE IS NO NET INCREASE IN THE IMPERVIOUS AND THE EXISTING BMPs ARE ADEQUATE TO PROVIDE STORMWATER MANAGEMENT.

**AUTOTURN LAYOUT
SCALE 1" = 10'**

NEW ASPHALT PAVEMENT

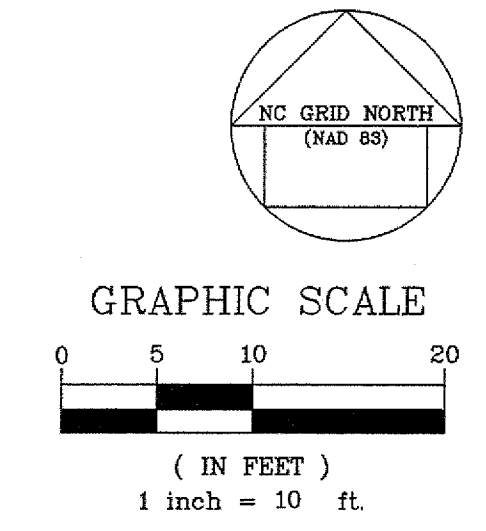

CONSTRUCTION TO BE IN ACCORDANCE WITH THE CURRENT CITY OF RALEIGH AND NCDOT STANDARDS AND SPECIFICATIONS.

WSP - SELLS
Transportation & Infrastructure
15401 Weston Parkway Suite 100 • Cary, NC 27513 • 919.678.0035
www.wspells.com

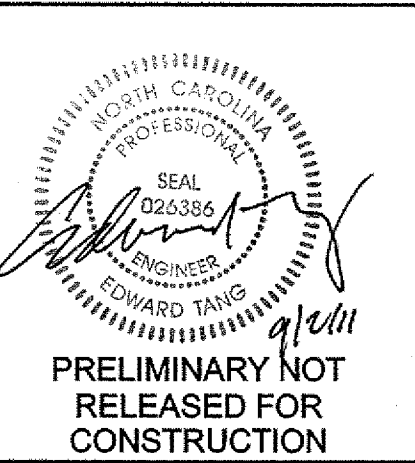

**HARRIS TEETER #367
PHARMACY DRIVE-THRU**
RALEIGH, NORTH CAROLINA
ARCONS DESIGN STUDIO
7821 LITTLE AVENUE
CHARLOTTE, NC 28226

REVISIONS	DATE

PROJECT # 11-4020 DATE: 09/05/11
DRAWN BY: ET CHECKED BY: ET
TITLE
AUTOTURN PLAN
SHEET
C1.2

© WSP SELLS ALL RIGHTS ARE RESERVED. ANY POSSESSION, REPRODUCTION OR OTHER USE OF THIS DOCUMENT WITHOUT PRIOR PERMISSION FROM WSP SELLS, IS EXPRESSLY PROHIBITED.