

EXISTING VINYL COATED
SUSPENDED CEILING SYSTEM

EXISTING QUARRY TILE BASE

EXISTING QUARRY TILE FLOOR

3 MEAT/ SEAFOOD PREP AREA



EXISTING VINYL COATED
SUSPENDED CEILING SYSTEM

EXISTING QUARRY TILE FLOOR

2 DELI/BAKERY PREP AREA

| NO. | CONVENIENCE FOOD EQUIPMENT | QUANTITY | MODEL # | MANUFACTURER |
|------|-----------------------------------|----------|-----------------|--------------|
| M1 | 4 DOOR FROZEN MEAT/ SEAFOOD | 2 | ICE CREAM RATED | HUSMANN |
| M2 | 6' FRESH MEAT | 2 | M5X6EP | HUSMANN |
| M3 | 12'-0" SERVICE/ SELF-SERVICE MEAT | 2 | CR3-M-12 | HUSMANN |
| M4 | 6' REFRIG. SEAFOOD | 1 | M-04 | HUSMANN |
| M5 | 3 DOOR FROZEN SEAFOOD | 1 | ICE CREAM RATED | HUSMANN |
| M6 | MICRO STEAMER | 1 | NE215TR | PANASONIC |
| M7 | SCALE | 2 | - | - |
| ME1 | LUNCH MEAT RETROFITTED W/DOORS | 3 | D8D12HX | - |
| ME2 | FRESH MEAT | 2 | M5X6R12HX | - |
| ME3 | LOBSTER TANK | 1 | SSH-2 | - |
| ME4 | 6' OPEN TABLE WITH UNDERSHELF | 1 | RJ T65 | - |
| ME5 | 6' CEILING MOUNT MEAT TRAY RACK | 2 | M3T | - |
| ME6 | MEAT SAH | 2 | M10 | - |
| ME7 | MEAT CUTTING TABLE | 2 | M5 | - |
| ME8 | 3-ROLL WRAPPER WITH I WING | 2 | M4A | - |
| ME9 | BELT SEALER (HOBART) | 1 | M15 | - |
| ME10 | 5' MEAT CONVEYOR | 1 | M3L-5 | - |
| ME11 | AUTO LABELER | 1 | M12L | - |
| ME12 | ROTARY BIN FOR AUTO LABELER | 1 | M15 | - |
| ME13 | LABEL HOLDER (GLS) | 1 | M66 | - |
| ME14 | 3'- COMP SINK | 1 | - | - |
| ME15 | HAND LAV. | 2 | - | - |
| ME16 | SLICER | 2 | M52 | - |
| ME17 | TABLE | 1 | M50 | - |
| ME18 | 1'- COMP SINK | 1 | - | - |
| ME19 | STORAGE RACKS | 6 | - | - |
| ME20 | TABLE | 1 | T65 | - |
| ME21 | TABLE | 1 | GE11 | - |
| ME22 | SEAFOOD FREEZER | 1 | S20TSC2 | - |
| ME23 | TABLE | 1 | - | - |
| ME24 | STORAGE | 1 | GEH | - |

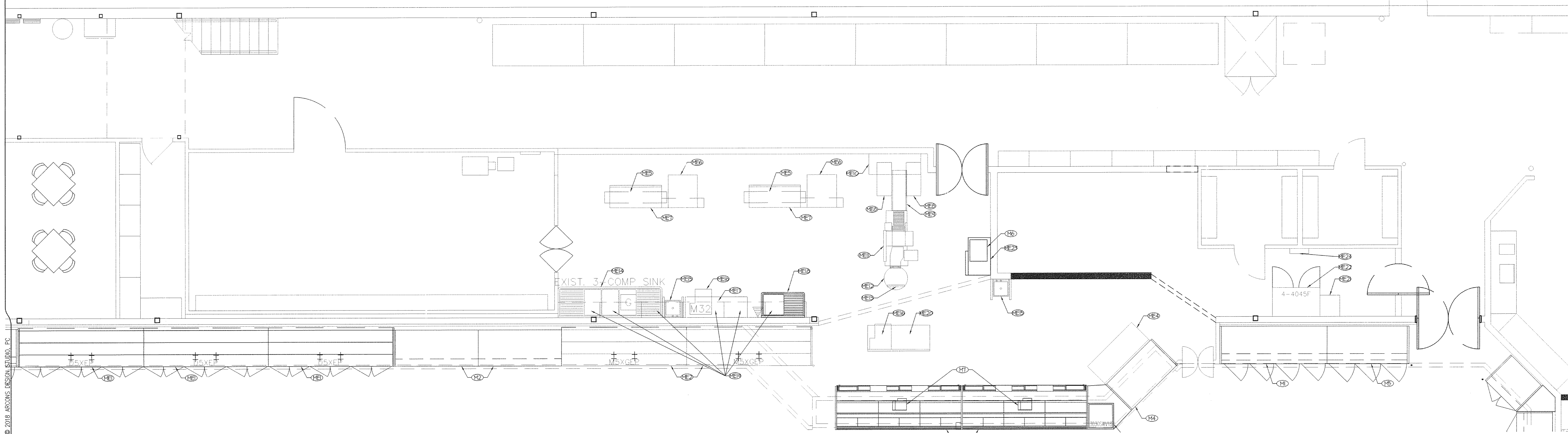

1 ENLARGED MEAT/ SEAFOOD PREP PLAN
SCALE: 1/4" = 1'-0"

ARCONS DESIGN STUDIO
architecture planning interiors
10550 Independence Pointe Parkway
Suite 300
Matthews, North Carolina 28105
P: 704-542-5252 F: 704-542-2330

SEALLABEL

ARCONS DESIGN STUDIO, PLLC
REGISTERED ARCHITECTURE FIRM
51553
NORTH CAROLINA
CHARLOTTE, N.C.

Professional Engineer Seal
JAMES D. BINK
REGISTERED PROFESSIONAL ENGINEER
11/14/16

Harris Teeter
Your Neighborhood Food & Pharmacy

HARRIS TEETER INC.
101 CREEDDALE RD.
MATTHEWS, NC 28105
PH: 704-844-5100

HARRIS TEETER #495
8345 CREEDMOOR
RALEIGH,
NORTH CAROLINA

PROJECT MANAGER: Rajeev Bhow

JOB NO.: 18-0495-02

DR. BY: TACH

REVISIONS:

| No. | Date |
|-----|----------|
| 1 | 10/21/18 |
| | |
| | |
| | |
| | |
| | |
| | |
| | |
| | |
| | |

SHEET NAME:
ENLARGED MEAT/ SEAFOOD PREP AREA

SHEET NO.: **HD2**

DATE: 10/22/18